



Battery Compartment Drain Hose Upgrade Kit

Models: T350, Speed Scrub 350



This kit is intended for machines manufactured before serial number 10945380 (March 27, 2019).

It includes the necessary parts to upgrade the battery compartment drain hose assembly to prevent the risk of any potential battery fluid leaks. Carefully install the upgrade kit as instructed.

INSTALLATION INSTRUCTIONS:

Installation Time: 0.5 hours

Special Tools Required: None

9019340 - Kit Contents

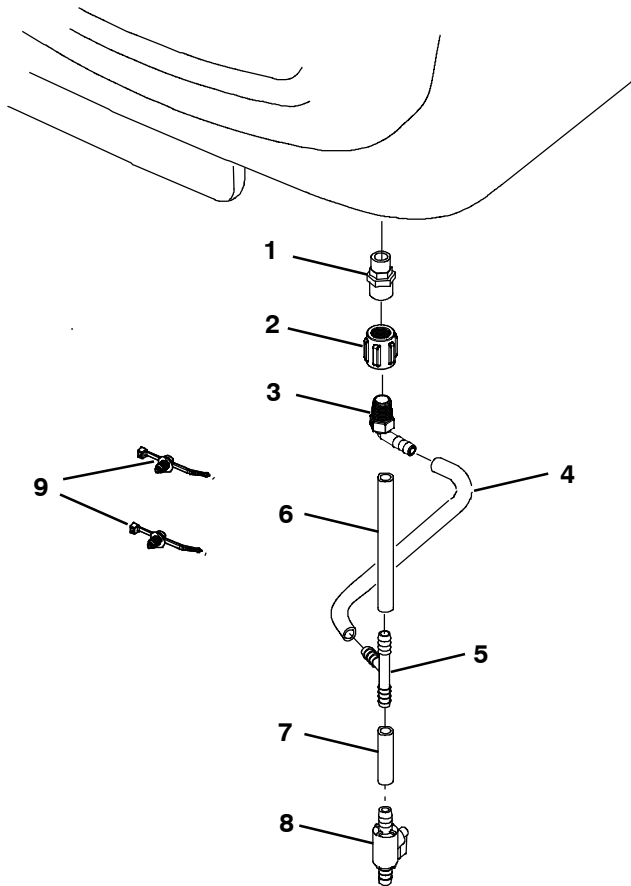

Item	Part No.	Description	Qty.
1	1247602	Fitting, plstc, str, pm06/pm06, pyp	1
2	1247605	Fitting, plstc, str, pf06/pf06, pyp	1
3	1247579	Fitting, plstc, e90, bm06/pm06, pyp	1
4	1014939	Hose, pvc, clr, .38id, 7.3" l	1
5	1247259	Fitting, plstc, tee, bm06/bm06/bm06, pyp	1
6	1014939	Hose, pvc, clr, .38id, 6.5" l	1
7	1014939	Hose, pvc, clr, .38id, 2" l	1
8	1233940	Valve, Ball, bm06/bm, pvc, w/handle	1
9	1210807	Wire, tie [w/.25" fir tree clip]	2



FOR SAFETY: Before servicing machine, wear personal protection equipment. Avoid contact with battery acid.

1. Check the battery compartment for any liquid build-up. If liquid is present, drain the compartment in an area where the liquid can be safely drained. The drain valve is located under the front, left side of machine.
2. Park machine on level surface and remove key.
3. Remove the existing battery compartment drain hose assembly from machine and discard. If exposed to battery liquid, neutralize the old parts with a mixture of water and baking soda.
4. Install the upgrade kit as shown. To ease installation, pre-assemble fittings (items 1, 2 and 3) before installing on machine. Use a chemically compatible pipe thread sealant on the PVC fittings (i.e. Loctite MR5438 or equivalent).
5. After installing upgrade kit, fully turn the drive wheel in both directions to ensure wheel does not come in contact with hose assembly. Adjust hose assembly accordingly to eliminate any interference.

